

 Create pdf

BJB///OEM-Line

28.301.1002

GH76p Lampholder for E-Core LED Light Engine from Toshiba

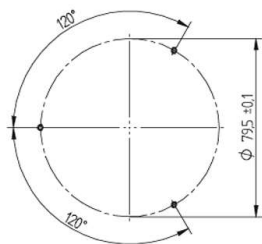
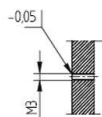
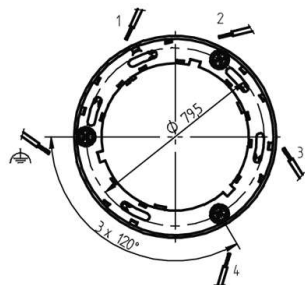
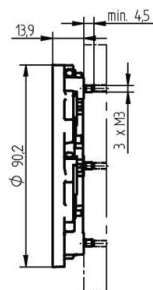

pkg. wt. part no.
144 20 g 28.301.1002.90

Suitable for the following LED models:

<u>Manufacturer</u>	<u>LED model</u>
Panasonic	GH76p
Toshiba	E-Core LED Light Engine GH76p



Key: GH76p-2 for LED light engines 220-277 V AC

Approval: additional cULus

Screw fixing

Material: PPS/PC

- Lampholder is delivered fully assembled with M3 fixing screws included
- Screw fixing holes M3 recommendation: sharp-edged without countersink
- Torque recommendation: 0.5 - 0.6 Nm
- Screws are equipped with an one time loosening protection. After disassembly and a second assembly, the user is responsible for loosening protection
- Marking of contacts: 1. Neutral 2. Phase 3. Dim 4. Dim 5. Functional ground

LED-LINE				2 A 250 V
		0.5 - 0.75 mm ²	0.5 - 0.75 mm ²	

Document generated on: Th, 2. February 2017 - 17:03